

# Installation Instructions for Flexible Entry Hubs

This instruction covers the installation of the freeflo™ flexible entry hubs (FEH-0125 thru FEH-0800). The freeflo™ flexible entry hubs are designed for easy installation and to allow variation in the inlet pipe entry. The freeflo™ FEH series hubs have an accordion design boot to limit the stress on the hub. However, it is important to keep the inlet pipe entry angle between 0 degrees to 15 degrees to prevent added stress on the inlet pipe. It is also important to never locate the FEH series hub on the bottom of any basin or collection tank.

The freeflo™ FEH series hub comes with the entry hub and all of the required fasteners to secure to the basin or tank (see figure below). A drilling template is also included to aid in locating and drilling mounting holes. The following tools are required to install the freeflo™ FEH series hub:

- 1) Cordless or Electric Drill
- 2) 5/16" Diameter Drill Bit
- 3) 7/16" Socket
- 4) De-burring Tool
- 5) Hole Saw per Chart
- 6) Magic Marker
- 7) Rubber Mallet

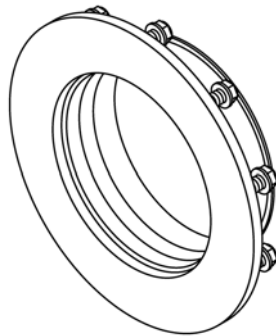

## Installation Procedure

- 1) Locate the position on the basin or tank, where the inlet is to be located.
- 2) Place the provided template on the selected inlet position. The template is marked with the freeflo™ catalog number, so based on the model that is being installed select the appropriate hole pattern.
- 3) Using a 5/16" diameter drill bit, drill all of the holes for the FEH series hub being installed.
- 4) Using a hole saw (see chart for appropriate size) and the pilot hole in the center of the provided template, drill out center area to allow the FEH series boot to fit thru the basin or collection tank wall.

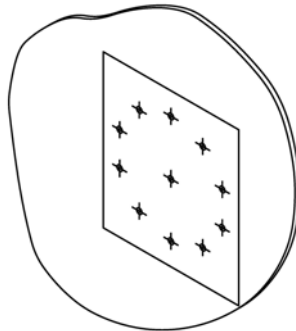

- 5) Remove all rough edges using the de-burring tool. Then place the FEH series hub into the tank with the threaded studs toward the inside of the tank. (Note: it is a good practice to use a marine grade urethane sealant as well).

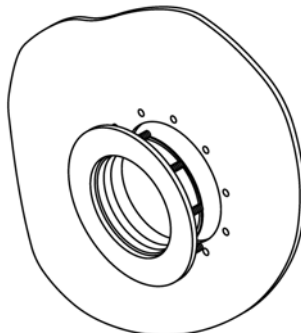

- 6) Using the provided fasteners and a 7/16" socket secure the FEH series hub to the basin or tank wall. When tightening use a "X" pattern to make sure the hub has equal compression and seals to the tank wall.

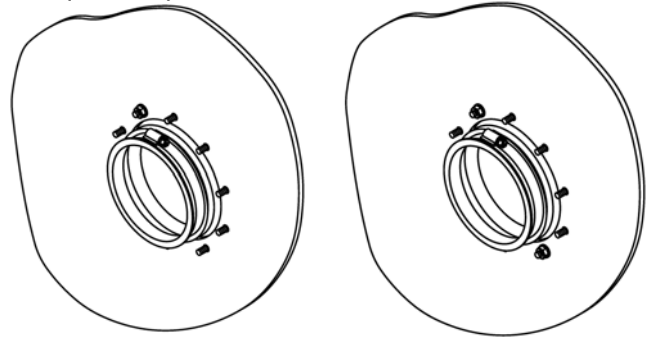

- 7) Before installing inlet pipe be sure to use soapy water before trying to push thru the hub. After sliding the inlet pipe thru the hub, use the provided clamp to tighten the hub to the pipe.

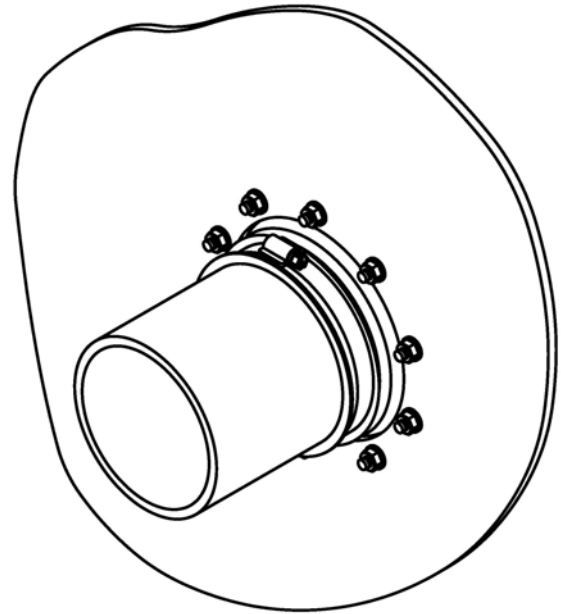

freeflo™ Model	Hole Saw Diameter
FEH-0125/FEH-0150	2-1/2"
FEH-0200	3-1/2"
FEH-0300	4-1/2"
FEH-0400	5-1/2"
FEH-0600	7-1/2"
FEH-0800	9-1/2"

